

BILL OF MATERIAL

ITEM	QTY	PART #	DESCRIPTION	UNIT WEIGHT	TOTAL WEIGHT
1	2	3-PBR37-6B-306-ES1	S3X5.7# I BEAM	154.56	309.12
2	2	3-PSP-4X8	PALLET STDP PLATE 4x8	1.7	3.4
3	1	3-PBC2-4840-F	#2 CART	23.60	23.60
4	1	3-PBC3-4840-F	#3 CART	43.17	43.17
5	1	3-PBC4-4840-EF	#4 CART EXT	50.09	50.09
6	1	3-PBC5-4840-EF	#5 CART EXT	55.54	55.54
7	1	3-PBC6-4840-EF	#6 CART EXT	60.27	60.27
8	2	3-ZFB50-200	1/2 x 2 HEX HD BOLT	0.13	0.26
9	12	3-ZFFW.50	1/2 FLAT WASHER	0.03	0.36
10	2	3-B70060-00	RUBBER BUMPER 1 3/8 O.D. x 1 3/4 LONG	0.14	0.28
11	30	3-ZFN.50FG	1/2 HEX FLANGED WHIZ NUT	0.04	1.20
12	8	3-ZFB50-100	1/2 x 1 HEX HD BOLT	0.08	0.64
13	20	3-NPD10700Z	CART WHEEL 2.25 O.D. x 1.40	0.68	13.60
14	20	3-12-14X1	#12 x 1 HEX HD TEK SCREW	0.10	2.00
TOTAL WEIGHT				563.53	

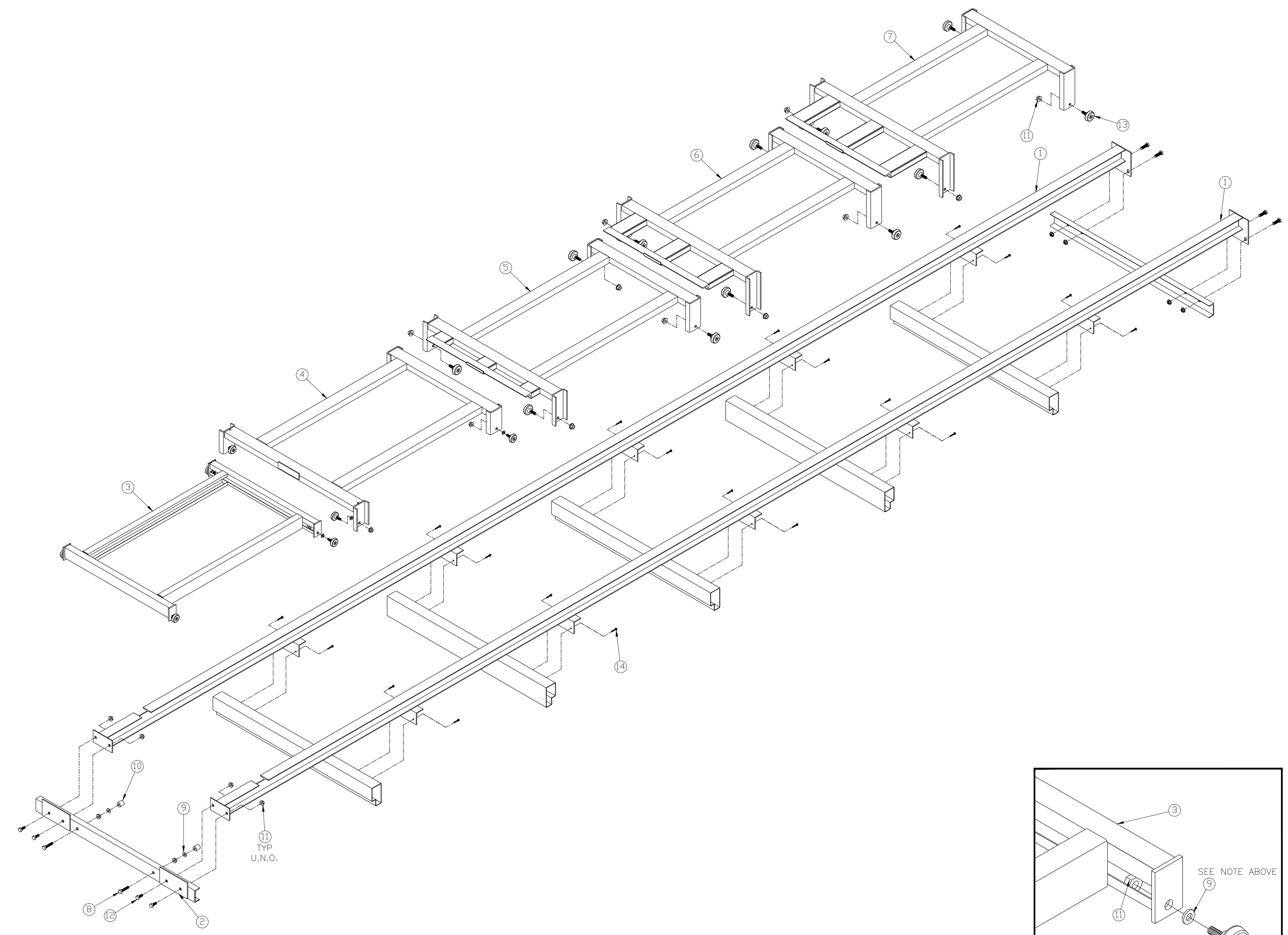

NOTE:  
 1. NO MORE THAN 3/8" TOTAL SIDE MOVEMENT OF CARTS ALLOWED. USE 1/2" WASHER TO ADJUST AS NECESSARY.  
 2. CARTS SHOWN ARE A REPRESENTATION OF THE CARTS TO BE INSTALLED.

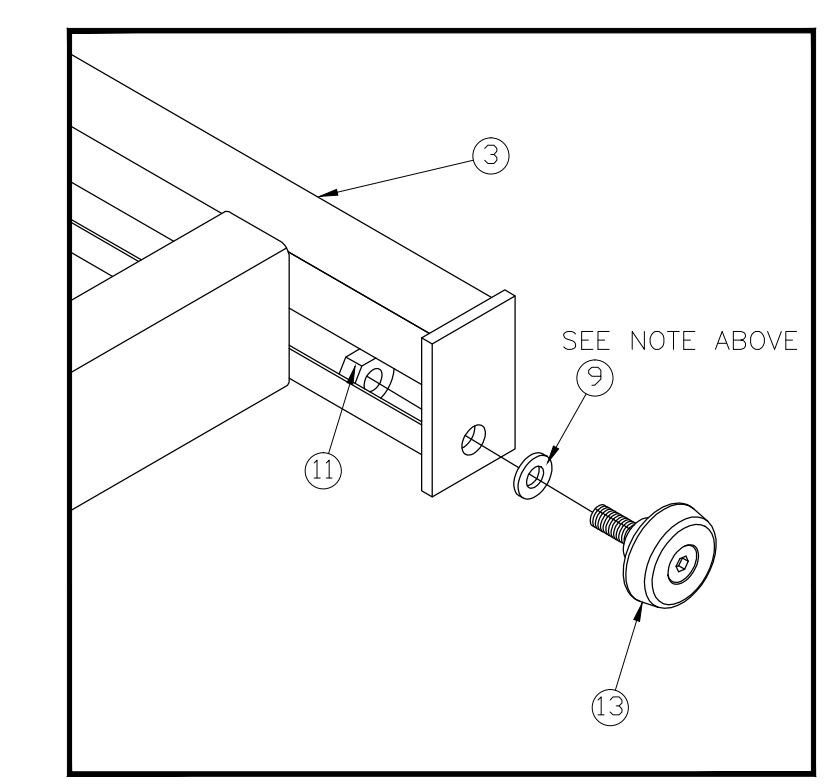

CART 2 WHEEL CONNECTION DETAIL

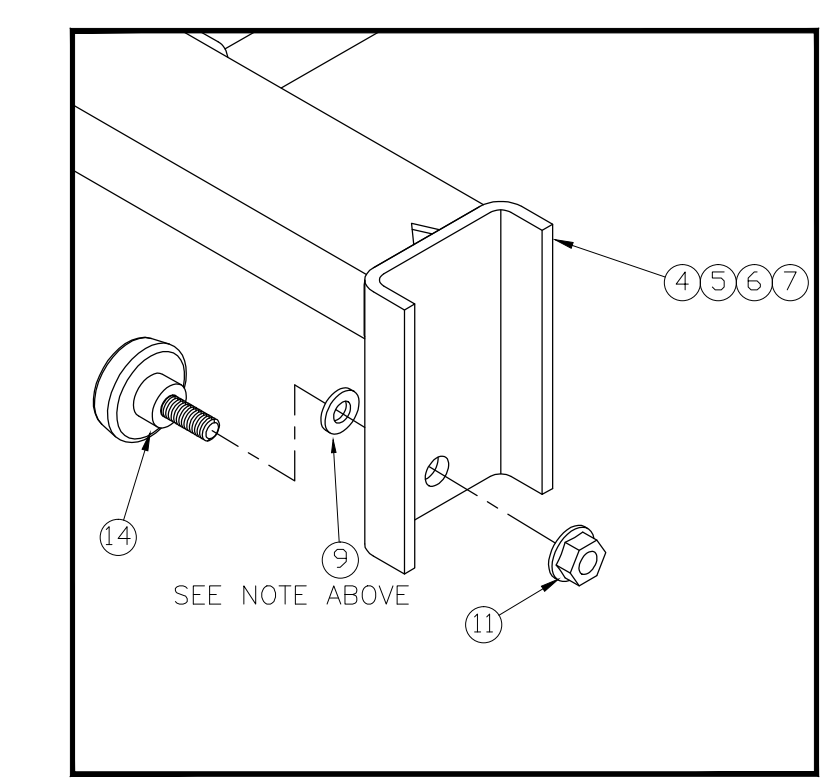

CART 3, 4, 5 & 6 FRONT WHEEL CONNECTION DETAIL

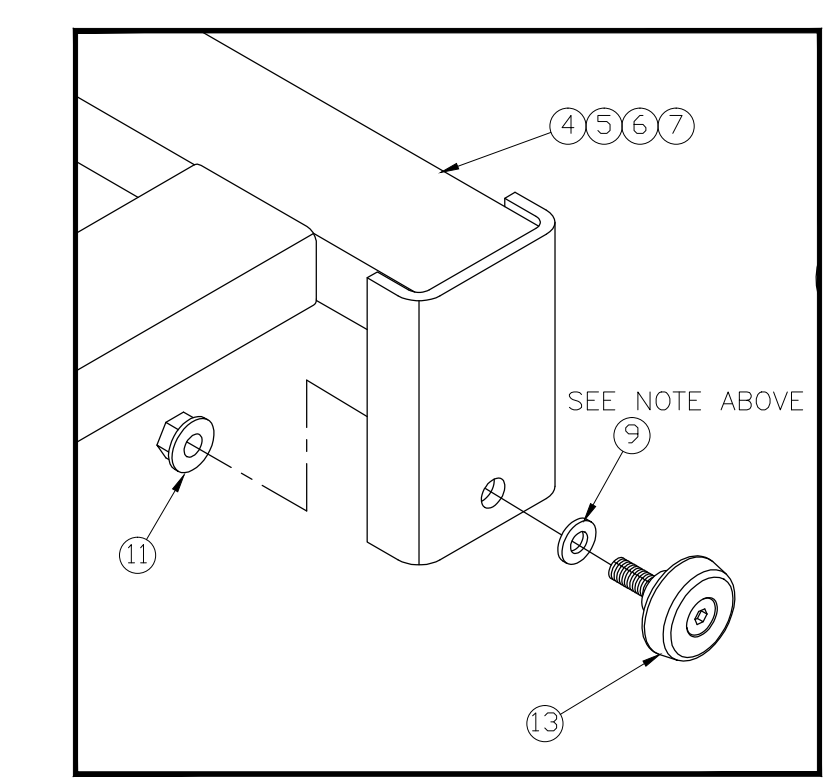

CART 3, 4, 5 & 6 REAR WHEEL CONNECTION DETAIL

PUSHBACK NOTE:  
 1) TYPICAL SLOPE IS 5/16" PER 12"



REV	BY	DATE	APP'D	REVISIONS

**UNARCO**  
 MATERIAL HANDLING  
 701 16th AVE EAST  
 P.O. BOX 547  
 SPRINGFIELD, TN 37172  
 PH: 615-384-3531 FAX: 615-384-8468

DRAWN	DATE	DESCRIPTION
JAE	10-04-13	6 DEEP PUSHBACK ASSEMBLY
CHECKED	DATE	USED ON
APP'D	DATE	QUOTE NO

JOB NO	DRAWING NO	REV.